

## GUARANTEE

Register for 24 Month Warranty on-line at <http://www.jpltele.com/product-registration>.

Your JPL product has been carefully manufactured and 100% tested using high quality assured components. It is guaranteed against faulty workmanship and materials for a period of 24 months from the date of purchase. In the unlikely event that a failure should occur, please contact the JPL dealer from which you purchased this product or visit [www.jpltele.com](http://www.jpltele.com) and follow our product returns procedure. You will be given a RMA number and instructions on how to return your headset.

Further help can be found on-line at [www.jpltele.com](http://www.jpltele.com) on our [FAQs](#) page.

**Note:** Removing the factory-applied warranty label on the back of the control unit will void the warranty. Specifically exempt from warranty are limited-life consumable components subject to normal wear and tear, such as microphone windscreens, ear cushions and other accessories. Your statutory rights under common law are in no way affected by this guarantee. The warranty does not cover cosmetic damage or damage due to misuse, abuse, negligence, acts of nature, accident, disassembling or modification of, or to any part of, the product. The warranty does not cover damage due to improper operation, maintenance or installation, or attempted repair by anyone other than JPL Telecom. Any unauthorised repairs will void this warranty.

### LIMITED WARRANTY

Consequential and incidental damages, including without limitation, loss of property and those arising from breach of any express or implied warranty, are not the responsibility of JPL Telecom and to the extent permitted by law, are excluded.

In accordance with its policy of progressive product design, JPL Telecom reserves the right to change product specifications without prior notice.

\* Repair or replacement is at the discretion of the manufacturer.

### REGISTERED ADDRESS

#### UK Office: JPL Telecom Limited

Unit 1, Church Close Business Park, Church Close, Todber, Sturminster Newton,  
Dorset, DT10 1JH England

#### USA Office: JPL Telecom Holdings LLC

445 W Merritt Ave, Merritt Island, FL 32953, USA

#### Mexico Office: JPL Telecom Mexico

Buffon 46-604, Col. Nueva Anzures, Delg. Miguel Hidalgo C.P. 11590

Registered in England No. 5250754

*(NB. For product returns, please follow instructions and returns department address provided on our website. Returned products received at the registered addresses are likely to be returned to sender).*

[www.jpltele.com](http://www.jpltele.com)



**JPL-Element-X500**

**User Guide**



## What's included

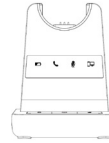

**Base Unit**



**Microphone Boom Arm**



**Monaural Headband**



**Switch Mode Power Supply with Multi Country Adapters & Telephone Cord**

## Optional Accessories

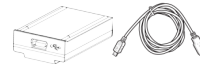

**USB 2.0 Module and USB Cable Type-A to Mini-B**



**Bluetooth Module**



**Monaural Headband**



**Binaural Headband**



**USB Cable Type-A to Micro USB for optional headset charging method**



**Microphone Boom Arm**



**JPL-DECT Lifter**



*Type of lead varies depending on phone model. Please refer to EHS Guide [www.jpltele.com/ehs-cables](http://www.jpltele.com/ehs-cables)*

**Electronic Hook Switch (EHS)**



## Attaching the headband

To attach the microphone boom arm to the headband, align the triangle shape on the microphone boom arm with the triangle shape on the headband and push to click into place. The microphone boom arm will then rotate to your required position.

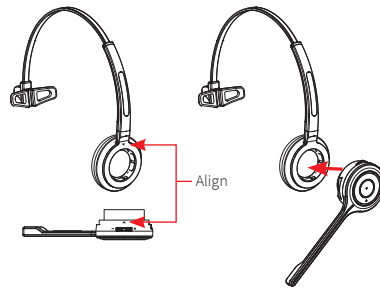

## Detaching the headband

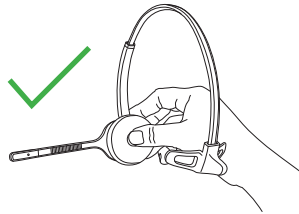

To detach the microphone boom arm from the headband, gently push the microphone speaker from inside the ear cushion. This will pop the microphone boom away from the headband.

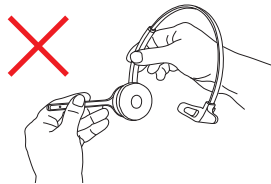

**DO NOT pull on the microphone boom to remove it from the headband.**

## Positioning the Microphone

The microphone boom arm is flexible, so you can gently bend the boom and position it to suit the curve of your face.

The ideal position for the microphone is at the corner of the mouth approximately 30mm (2 finger width) away from the mouth.

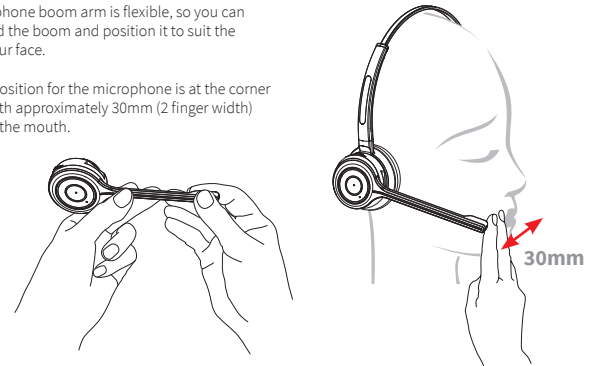

## Microphone Boom Volume Control

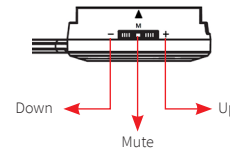

To change the speaker volume: roll the volume switch towards the 'plus' sign to increase the volume and roll the switch towards the 'minus' sign to reduce the volume and press the switch to activate the microphone mute mode.

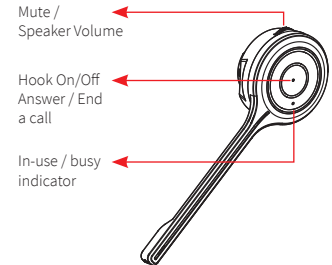

## Setting up the Base

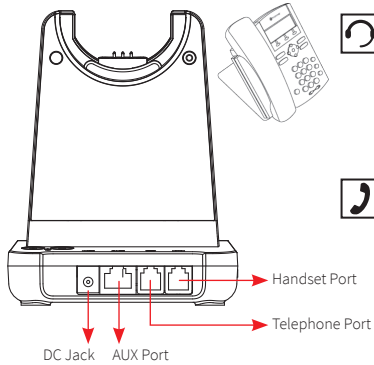

### Desk Phone with Headset Port

- Plug the supplied telephone cord into the TEL port of the BASE UNIT
- Connect the telephone cord to the HEADSET port of the desk phone



### Desk Phone without Headset Port

- On the desk phone, unplug the handset cable from the phone
- Plug the handset cable into the HANDSET port on the BASE UNIT
- Plug the telephone cord into the TEL port of the BASE UNIT and plug the other end of the telephone cord into the HANDSET port on the desk phone

## Operating Instructions

- Plug the Power Adapter DC Jack into the back of the Base Unit. (See **Note 1** below)
- Press the Hook On/Off switch to make a call
- Select compatibility switch position '1' or '2' until you can hear the dial tone
- Adjust speaker and microphone volume to suit your requirement
- Press the Hook On/Off switch to end a call

### Note 1 : Factory default setup : Pairing

- Place the headset on the cradle
- Plug the power adapter into the base unit (Pairing starts automatically as soon as you plug the power adapter into the Base Unit) The Tel indicator will start to flash.
- Press the 'mute button' of the headset until the LED of the headset starts flashing.
- Once pairing has completed, you will hear a beep sound and the LEDs of the base and headset will be off.

(Make sure that the headset is placed on the cradle before power is turned on. If the headset is not placed on the cradle, pairing will be unsuccessful).

## Base Unit

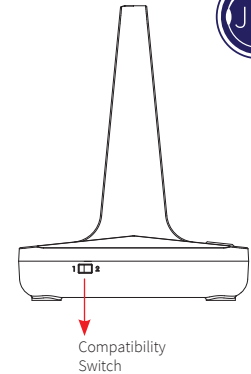
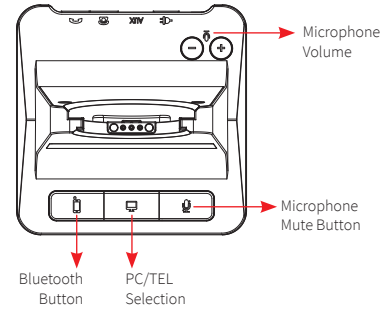

<b>Bluetooth Button</b>	This function works when the Bluetooth module is inserted
<b>PC/TEL Selection</b>	This function works when the USB cartridge is inserted
<b>Microphone Mute Button</b>	Press to mute the call
<b>Microphone Volume</b>	Your headset has automatic audio configuration, (this can take a few minutes to settle) however, if required, you can adjust the volume level for the speakers and microphone to suit
<b>Compatibility Switch</b>	Select '1' or '2' until a dial tone is heard via the telephone connection

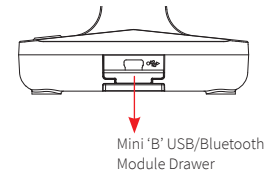
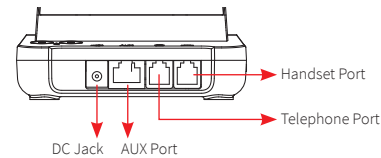

<b>DC Jack</b>	Connect Power Adapter to DC Jack
<b>AUX port</b>	Connection for Handset Lifter or EHS Adapter (optional extra)
<b>Telephone Port</b>	Connect telephone cord to the handset port or handset port of a telephone / base unit
<b>Handset Port</b>	Plug Handset cord from the phone to Handset port



## Base Unit

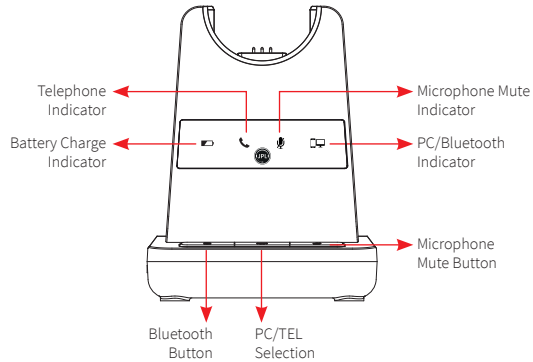

## Visual Indicator

Charging Status	LED Status
Charging	Battery Indicator: 'Flashing' 1 sec-ON, 1 sec-OFF
Fully Charged	Battery Indicator: 'ON'
Low Battery	Battery Indicator: 'Flashing' 0.5 sec-ON, 0.5 sec-OFF

Event	LED Status
Press Microphone Mute	Mute Indicator: 'ON'
Press PC/TEL Selection	PC/TEL Indicator - TEL: 'OFF' PC: 'ON'
Hook Off	Selected Mode Indicator: 'ON'

## Audio Indicator

Event	Sound Effect
Speaker / Microphone Volume	Beep Sound 'UP' - High Tone, 'DOWN' - Low Tone
Max/Min Speaker Volume	Double beep
Max/Min Microphone Volume	Double Beep
Microphone Mute/Unmute	Beep / Double Beep
Mute Reminder	Beep (every 3 seconds)
Hook Off / On	Double Beep (High Tone / Low Tone)

## Trouble Shooting

### 1. Cannot hear a dial tone.

- Check the PC/TEL button. TEL Mute: PC/TEL indicator – 'OFF'
- Please check the cable connection between Base Unit and Phone.
- Check that the power adapter is plugged in and has power
- Please check the compatibility switch. Adjust compatibility switch until you can hear the dial tone.

### 2. Microphone volume (TX) is low / dead.

- Make sure that the microphone (TX) mute function is deactivated.
- Check the position of the boom arm and make sure that the microphone is placed as close as possible to your mouth (approx. 2 fingers distance).
- Adjust the microphone (TX) volume on the bottom of Base Unit.

### 3. Buzzing sound on the headset

- Telephone may not be fully immune to the radio transmission between your headset and Base Unit. To overcome this problem, move the Base Unit to at least 30 cm/12" away from the phone.

### 4. Headset echoes

- Adjust the telephone's volume. If necessary, adjust your microphone volume on the headset to a lower setting.

### 5. EHS doesn't work with the telephone

- Make sure the telephone is compatible with the wireless headset. Refer to the EHS guide.

### 6. Headset was working, but it has stopped.

- Headset may need pairing to the Base Unit again. Refer to '**Note 1**' in the 'Operating Instructions'
- Headset battery may be dead. Return the headset to the cradle on the base unit for charging.

## Additional Accessories

### X500 Cartridge Module for USB Connection

- Softphone interoperability through USB/computer with 3CX, Avaya One-X, Cisco Jabber, Counter Path and Skype with assistance from the JPL Gateway.
- Before inserting your USB cartridge, make sure that the base unit is powered-off.

USB Cable Type-A to Mini-B

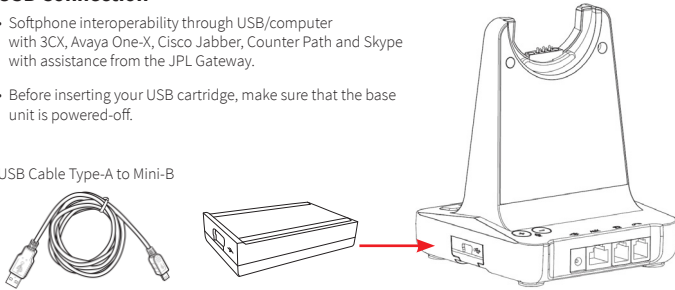

- After inserting the cartridge, connect the power and then connect the USB cable.
- To make a USB call, press the "PC/TEL" button.
- When you press the "PC/TEL" button, the "PC/TEL" LED will flash on and off.

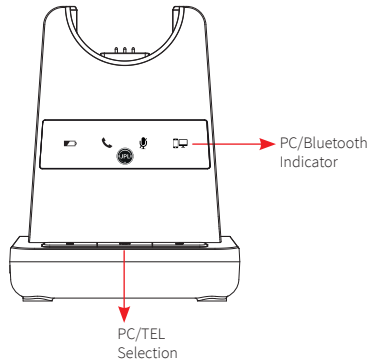

## Additional Accessories



### X500 Cartridge Module for Bluetooth Connection

- Bluetooth allows the DECT headset to connect wirelessly to any three Bluetooth devices simultaneously (mobile, dongle, tablet).
- This headset allows wireless conversations from any desk phone, softphone and mobile.
- Before inserting your Bluetooth cartridge, make sure that the base unit is powered-off.

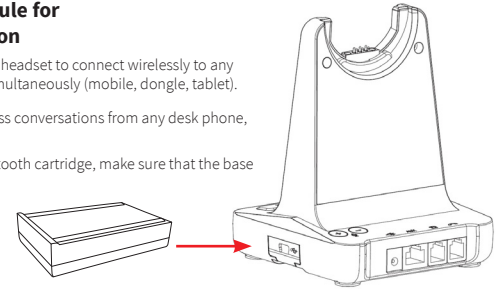

### JPL-DECT Lifter

- The JPL-DECT Lifter remotely lifts the desk phone handset to make or answer a call.

[www.jpltele.com/accessories](http://www.jpltele.com/accessories)

(Refer to the JPL-DECT Lifter installation guide).

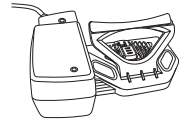

### Electronic Hook Switch (EHS) Adapter

- EHS Adapter enables an incoming call to be answered or ended by using the On/Off button on the Headset.



Type of lead varies depending on phone

[www.jpltele.com/ehs-cables](http://www.jpltele.com/ehs-cables) Refer to the EHS Compatibility Table to see which adapter you need for your desk phone. (Refer to the EHS Adapter installation guide to see how to install your EHS cable).

### USB Cable Type-A to Micro USB

- Optional method for charging the headset. Connect the micro USB jack to the micro USB port located on the side of the headset

